

Installation guide for Interlocking Rubber Mats - Equine

1. Tools you will require

Alignment

- Tape measure or ruler.
- Stringline.



Anchoring (if required)

- Hammer drill.
- Drill bit: 10mm for ANCB0 anchors.
- Hammer or rattle gun, depending on your fixing.



Cutting

- Felt marker pen, chalk or white out.
- Chalk line.
- Heavy duty box cutter/craft knife
- Spare blades.
- Lubricant, e.g. CRC 5.56 or WD40 or water.
- Steel straight-edge rule.



2. Numat will provide

- Interlocking mats.
- Edging (if and where required).
- Anchor bolts, plugs and finishing washers. (if required).

3. Preparation of concrete surface

Concrete must be in good condition.

Rubber matting must not be used to cover poor quality concrete. The concrete under-surface must be free of any large cracks, hollows and holes. Any exposed aggregate and any area of concrete that will cause effluent to pond or sediment to collect is non-compliant, and must be repaired or replaced.

Epoxy resins such as Cretex TR and Cretex SL are recommended for repair work. The concrete under-surface must be clean before any repairs are made and before the matting is installed.

4. Install at the correct temperature

Matting must be installed to these exact instructions. These provide joining tolerances for thermal contraction and expansion.

Rubber is a natural product and temperature will cause slight changes in size, with an extent of 0.2% per 10°C. Installation should be carried out in temperatures between 10°C and 25°C to mitigate any expansion and contraction.

The mats should be set aside for awhile near the installation site so they can adjust to the ambient temperature before they are laid.

Mats must not be fitted too tightly to avoid pressure build-up and bulging in hot conditions.

Continued

5. Laying out the mats

- Start at the straight edge.
- Retain a 5mm gap to the side edge.
- Cut interlock from edge mats - see cutting instructions (6) and edge profile (7).
- Lay out the complete area, joining mats corner-to-corner and interlocking each mat like a jigsaw.
- Put mats loosely together, lift both mats slightly and pull both mats apart slightly and evenly. At cold temperatures pull the interlock apart so there is a visible gap between the mats.

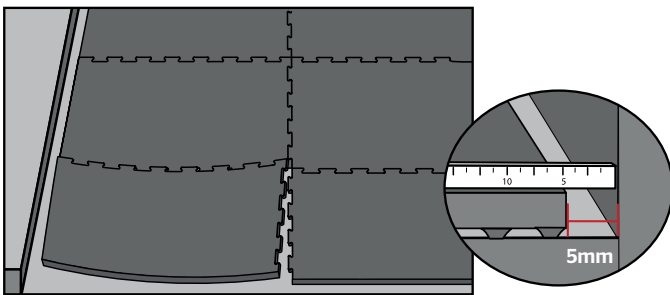

6. Cutting

- Edge mats should have the interlocks removed.
- Mark the mats to be cut with a marker pen or chalk line.
- Use a snap off blade and change the tip for each mat and moisten the knife with lubricant.
- Place mat over an edge or pallet or similar while cutting to open the cut, reducing friction on the blade. Run the knife along a steel straight-edge.
- Use a hole saw to cut 3-5mm into top of mats when cutting curves around poles. For clean cut, finish with knife, then over-cut with knife from bottom to ensure a snug fit.

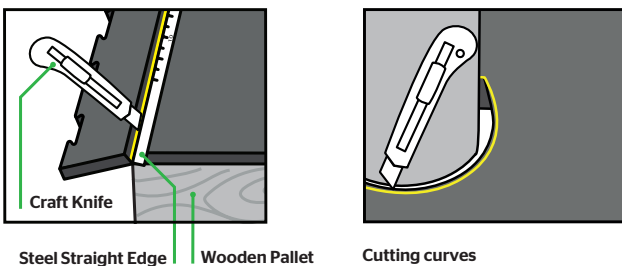

7. Fitting Stable Boxes

When fitting stable boxes side by side, we recommend carrying the off cut from one box through to the next.

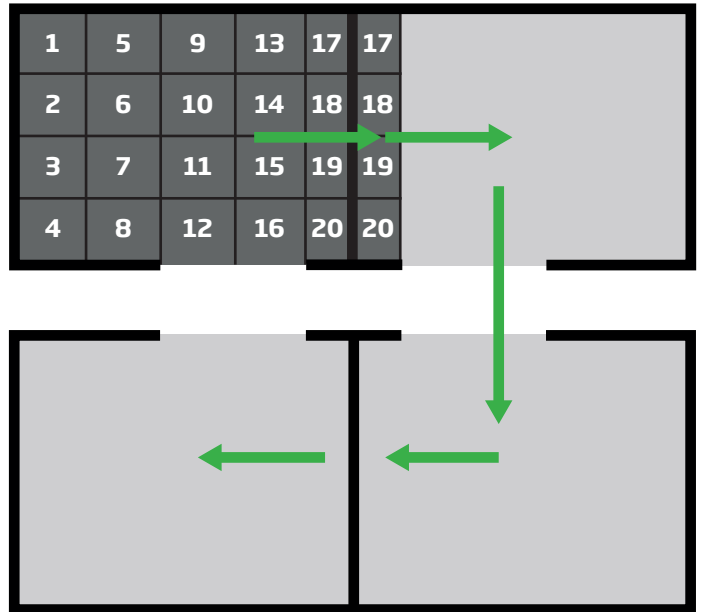

8. Anchoring

If anchoring is required, please refer to a NumatAgi specialist for assistance.

Diagram: ANC80 anchor system only

